

NOTE:
 ALL TRAFFIC SIGNAL DETECTION LOOPS IMPACTED OR MADE INOPERABLE BY MILLING, PAVING OR OTHER MAINTENANCE ACTIVITIES SHALL BE REPLACED AS PART OF THIS PROJECT. ALL DETECTION LOOPS SHALL BE REPLACED AT THEIR EXISTING LOCATIONS. DETECTION LOOP REPLACEMENTS SHALL BE COORDINATED WITH THE SR 8 RTOP CORRIDOR MANAGER.

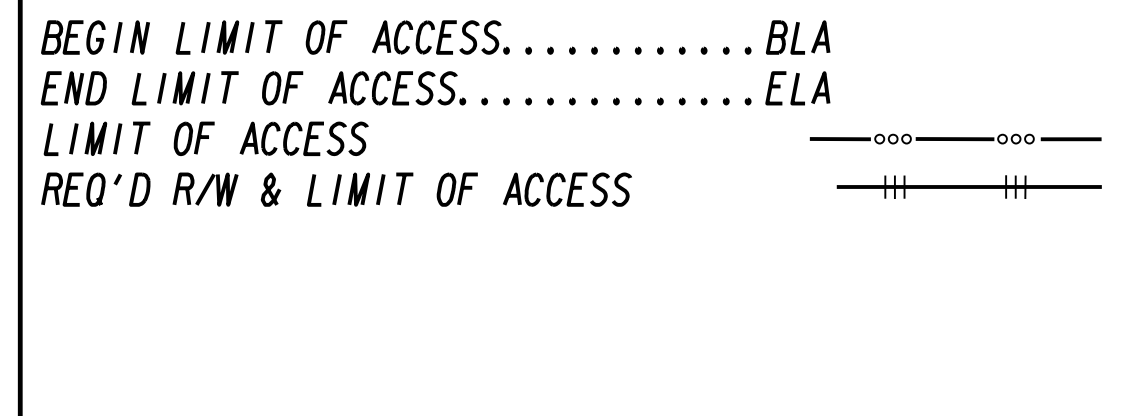

GEORGIA
 DEPARTMENT
 OF
 TRANSPORTATION

URS
 400 NORTHPARK TOWN CENTER
 1000 ABERNATHY ROAD, N.E., SUITE 900
 ATLANTA, GEORGIA 30328
 TEL: (678) 808-8800 FAX: (678) 808-8400

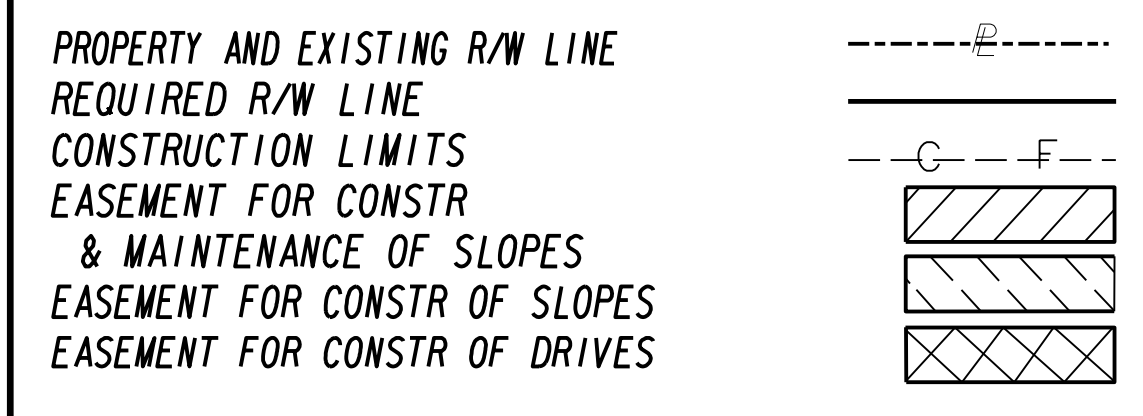

REVISION DATES

STATE OF GEORGIA
 DEPARTMENT OF TRANSPORTATION
 OFFICE: PROGRAM DELIVERY

SIGNING AND MARKING PLANS

SR 8 (PONCE DE LEON AVENUE)
 PEDESTRIAN SAFETY IMPROVEMENT

DRAWING No.
26-001

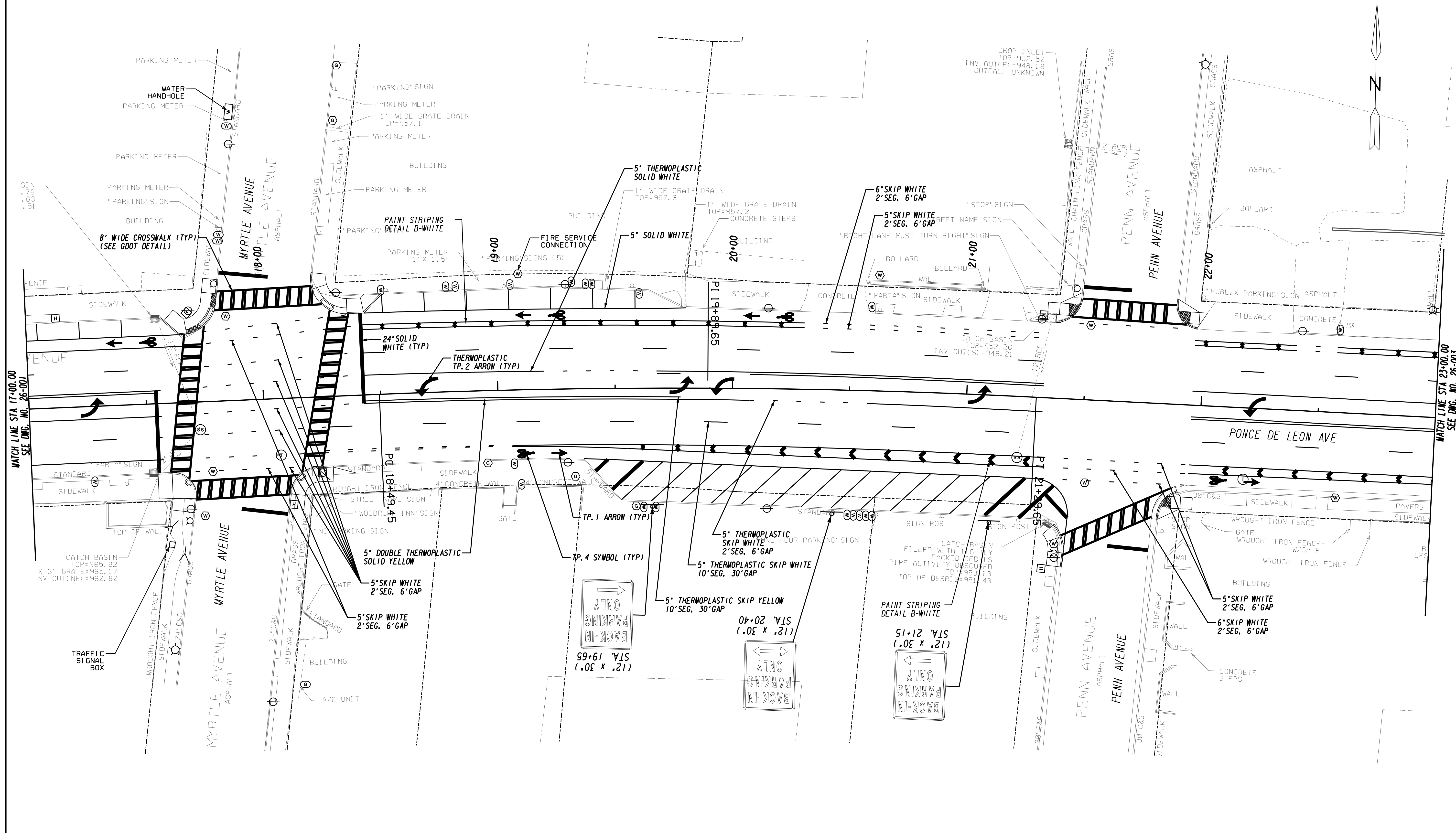

PROPERTY AND EXISTING R/W LINE
 REQUIRED R/W LINE
 CONSTRUCTION LIMITS
 EASEMENT FOR CONSTR
 & MAINTENANCE OF SLOPES
 EASEMENT FOR CONSTR OF SLOPES
 EASEMENT FOR CONSTR OF DRIVES

BEGIN LIMIT OF ACCESS.....BLA
 END LIMIT OF ACCESS.....ELA
 LIMIT OF ACCESS
 REQ'D R/W & LIMIT OF ACCESS

GEORGIA
 DEPARTMENT
 OF
 TRANSPORTATION

URS
 400 NORTHPARK TOWN CENTER
 1000 ABERNATHY ROAD, N.E., SUITE 900
 ATLANTA, GEORGIA 30328
 TEL: (678) 908-8800 FAX: (678) 808-8400

SCALE IN FEET
 0 20 40 80

REVISION DATES

STATE OF GEORGIA
 DEPARTMENT OF TRANSPORTATION
 OFFICE: PROGRAM DELIVERY
SIGNING AND MARKING PLANS

SR 8 (PONCE DE LEON AVENUE)
 PEDESTRIAN SAFETY IMPROVEMENT

DRAWING No.
26-002

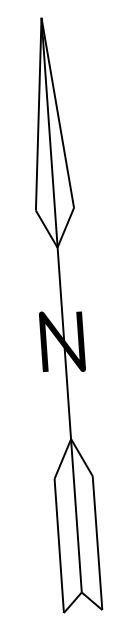
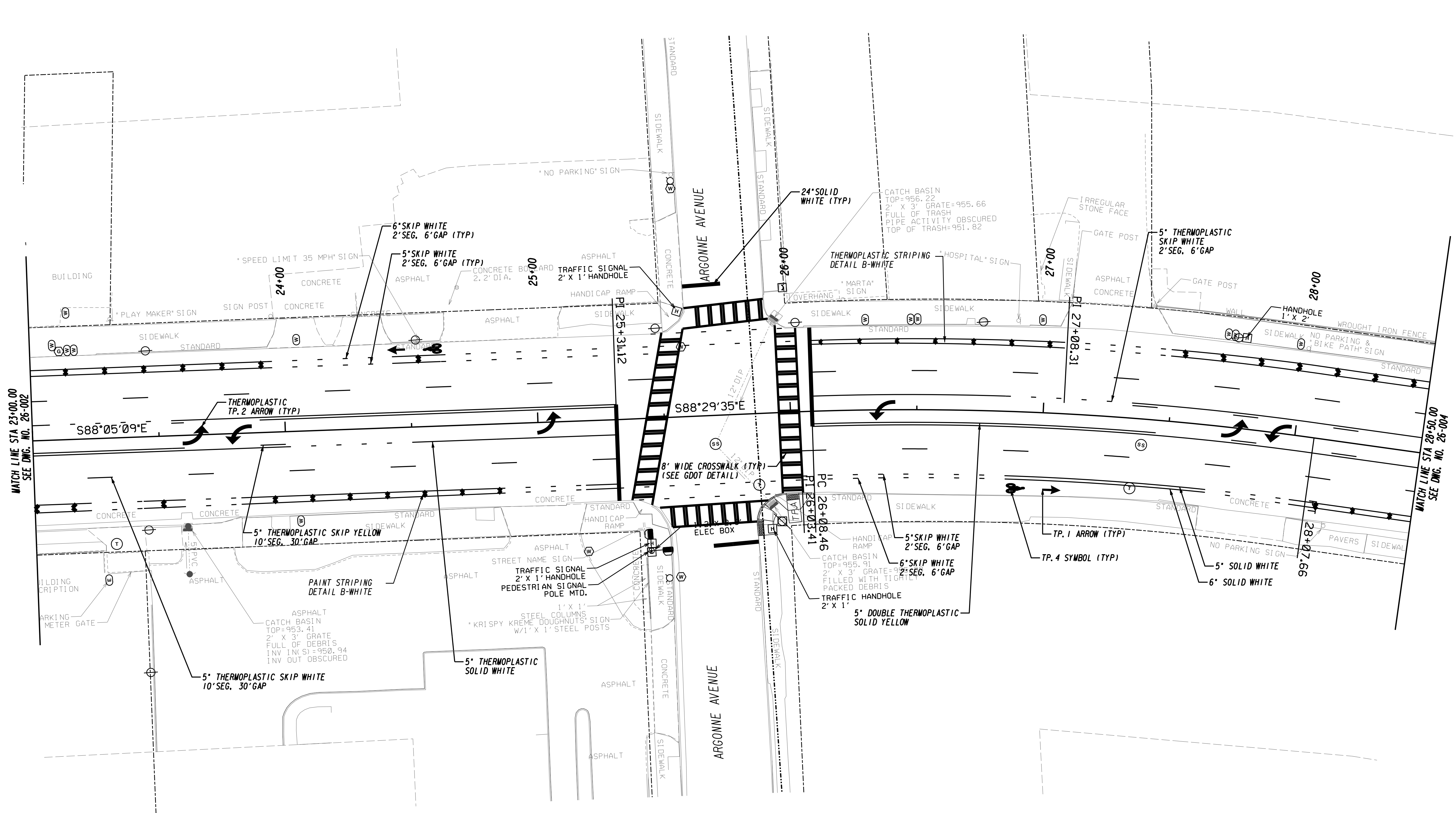

PROPERTY AND EXISTING R/W LINE
 REQUIRED R/W LINE
 CONSTRUCTION LIMITS
 EASEMENT FOR CONSTR
 & MAINTENANCE OF SLOPES
 EASEMENT FOR CONSTR OF SLOPES
 EASEMENT FOR CONSTR OF DRIVES

---@--- BEGIN LIMIT OF ACCESS.....BLA
 ---C--- END LIMIT OF ACCESS.....ELA
 ---F--- LIMIT OF ACCESS
 [Hatched Box] REQ'D R/W & LIMIT OF ACCESS
 [Hatched Box]

GEORGIA
 DEPARTMENT
 OF
 TRANSPORTATION

URS 400 NORTHPARK TOWN CENTER
 1000 ABERNATHY ROAD, N.E., SUITE 900
 ATLANTA, GEORGIA 30328
 TEL: (678) 808-8800 FAX: (678) 808-8400

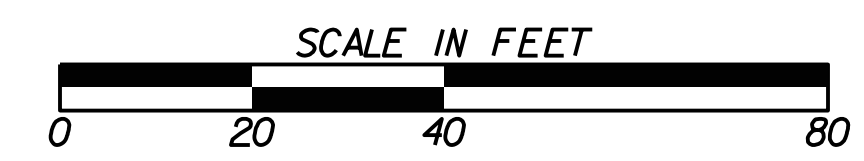

REVISION DATES	

STATE OF GEORGIA
 DEPARTMENT OF TRANSPORTATION
 OFFICE: PROGRAM DELIVERY
SIGNING AND MARKING PLANS
 SR 8 (PONCE DE LEON AVENUE)
 PEDESTRIAN SAFETY IMPROVEMENT
 DRAWING No. 26-003

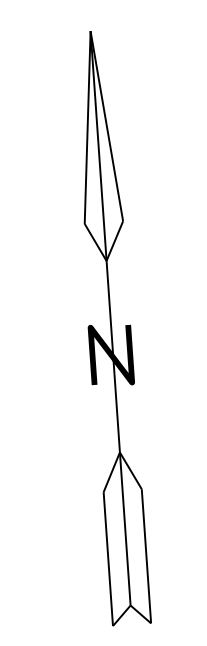
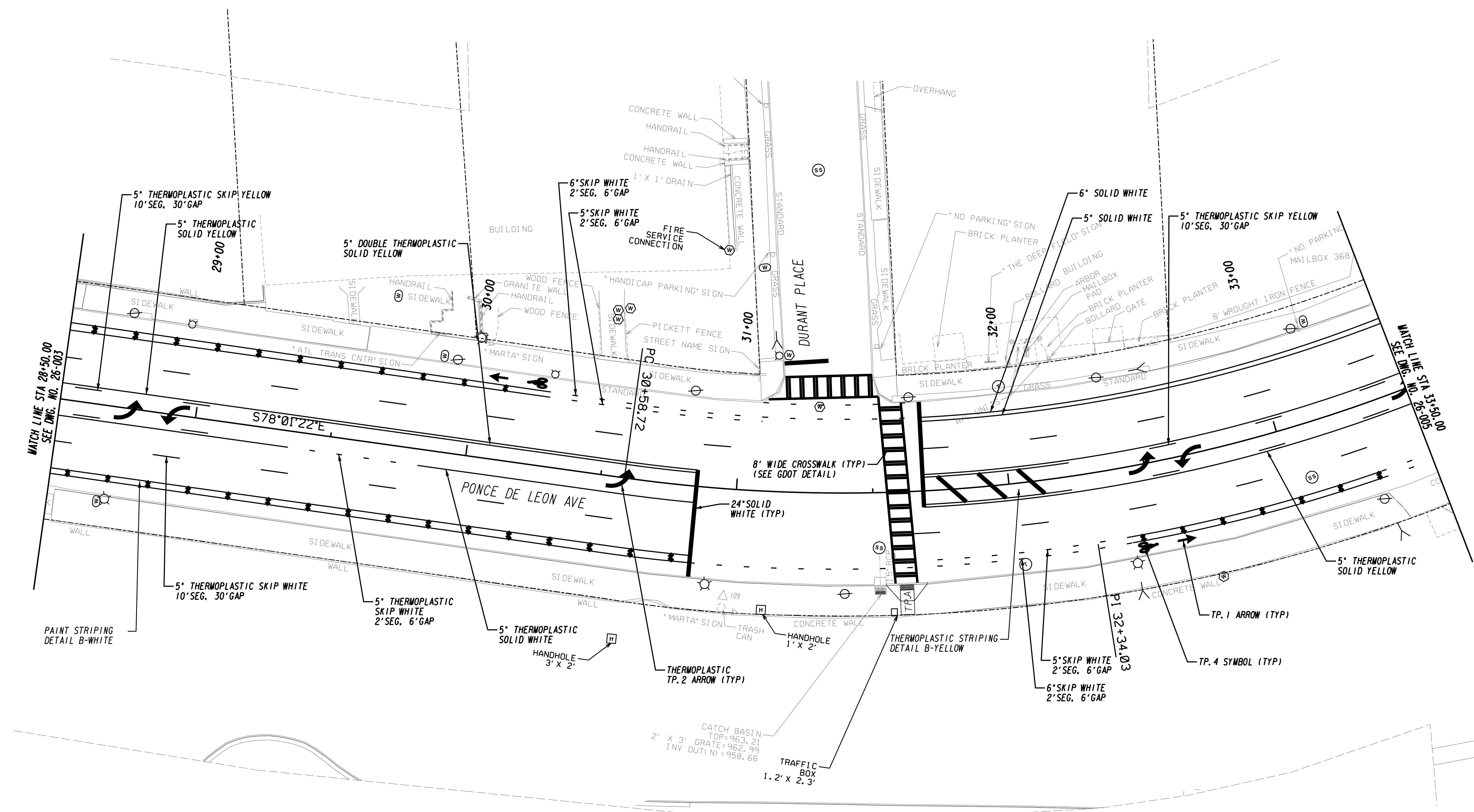

PROPERTY AND EXISTING R/W LINE
 REQUIRED R/W LINE
 CONSTRUCTION LIMITS
 EASEMENT FOR CONSTR
 & MAINTENANCE OF SLOPES
 EASEMENT FOR CONSTR OF SLOPES
 EASEMENT FOR CONSTR OF DRIVES

---@--- BEGIN LIMIT OF ACCESS.....BLA
 ---C--- END LIMIT OF ACCESS.....ELA
 ---F--- LIMIT OF ACCESS
 ---H--- REQ'D R/W & LIMIT OF ACCESS

GEORGIA
 DEPARTMENT
 OF
 TRANSPORTATION

URS 400 NORTHPARK TOWN CENTER
 1000 ABERNATHY ROAD, N.E., SUITE 900
 ATLANTA, GEORGIA 30328
 TEL: (678) 808-8800 FAX: (678) 808-8400

SCALE IN FEET
 0 20 40 80

REVISION DATES

STATE OF GEORGIA
 DEPARTMENT OF TRANSPORTATION
 OFFICE: PROGRAM DELIVERY
SIGNING AND MARKING PLANS

SR 8 (PONCE DE LEON AVENUE)
 PEDESTRIAN SAFETY IMPROVEMENT

DRAWING No.
26-004

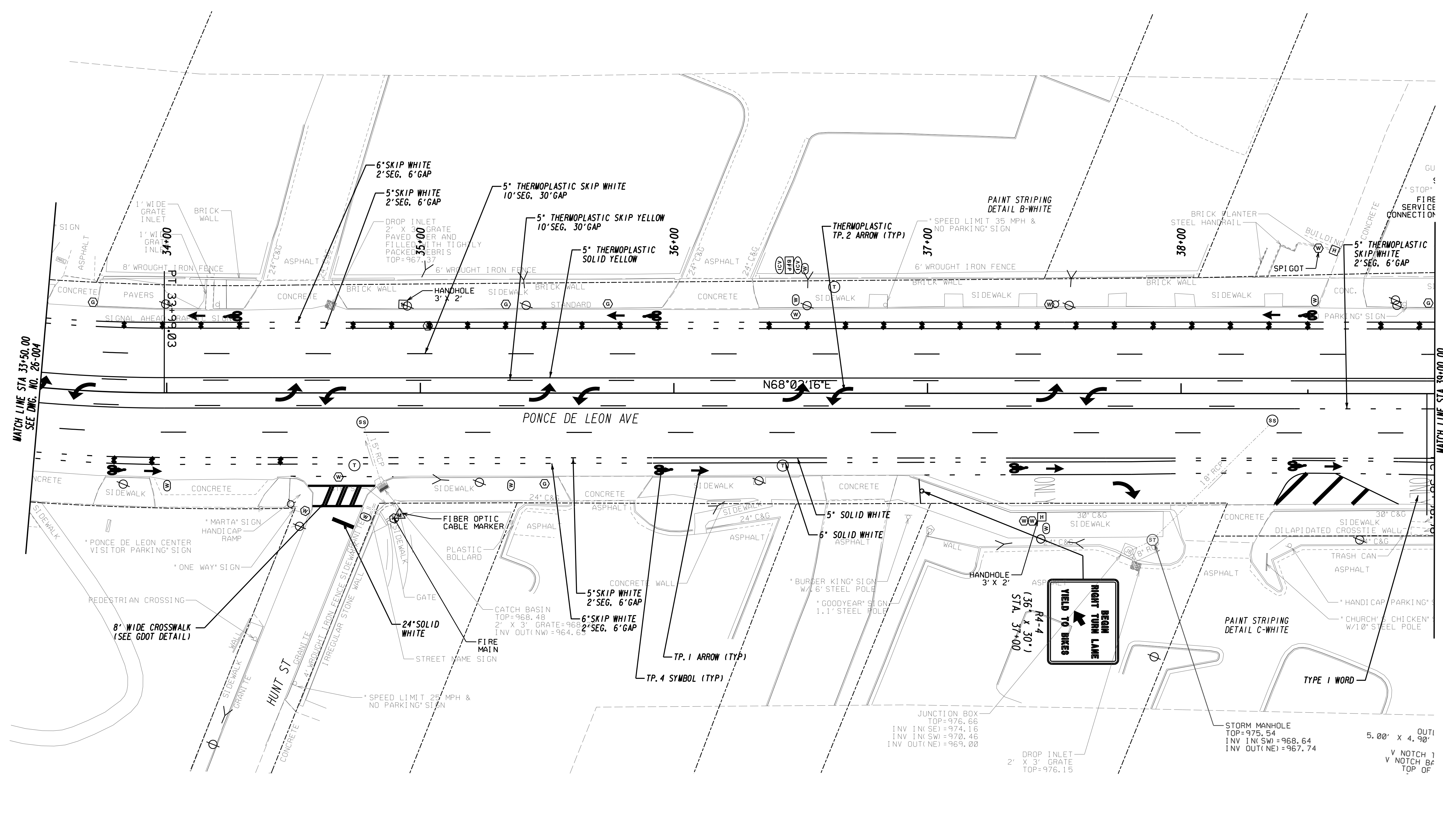

PROPERTY AND EXISTING R/W LINE
 REQUIRED R/W LINE
 CONSTRUCTION LIMITS
 EASEMENT FOR CONSTR
 & MAINTENANCE OF SLOPES
 EASEMENT FOR CONSTR OF SLOPES
 EASEMENT FOR CONSTR OF DRIVES

BEGIN LIMIT OF ACCESS.....BLA
 END LIMIT OF ACCESS.....ELA
 LIMIT OF ACCESS
 REQ'D R/W & LIMIT OF ACCESS

GEORGIA
 DEPARTMENT
 OF
 TRANSPORTATION

URS
 400 NORTHPARK TOWN CENTER
 1000 ABERNATHY ROAD, N.E., SUITE 900
 ATLANTA, GEORGIA 30328
 TEL: (678) 908-8800 FAX: (678) 808-8400

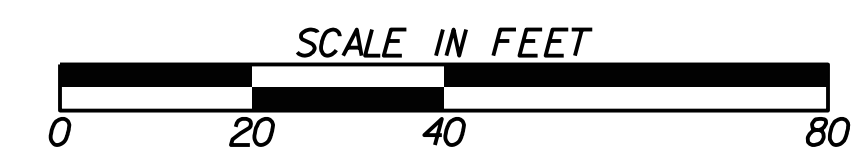

REVISION DATES	

STATE OF GEORGIA
 DEPARTMENT OF TRANSPORTATION
 OFFICE: PROGRAM DELIVERY
SIGNING AND MARKING PLANS

SR 8 (PONCE DE LEON AVENUE)
 PEDESTRIAN SAFETY IMPROVEMENT
 DRAWING No. 26-005

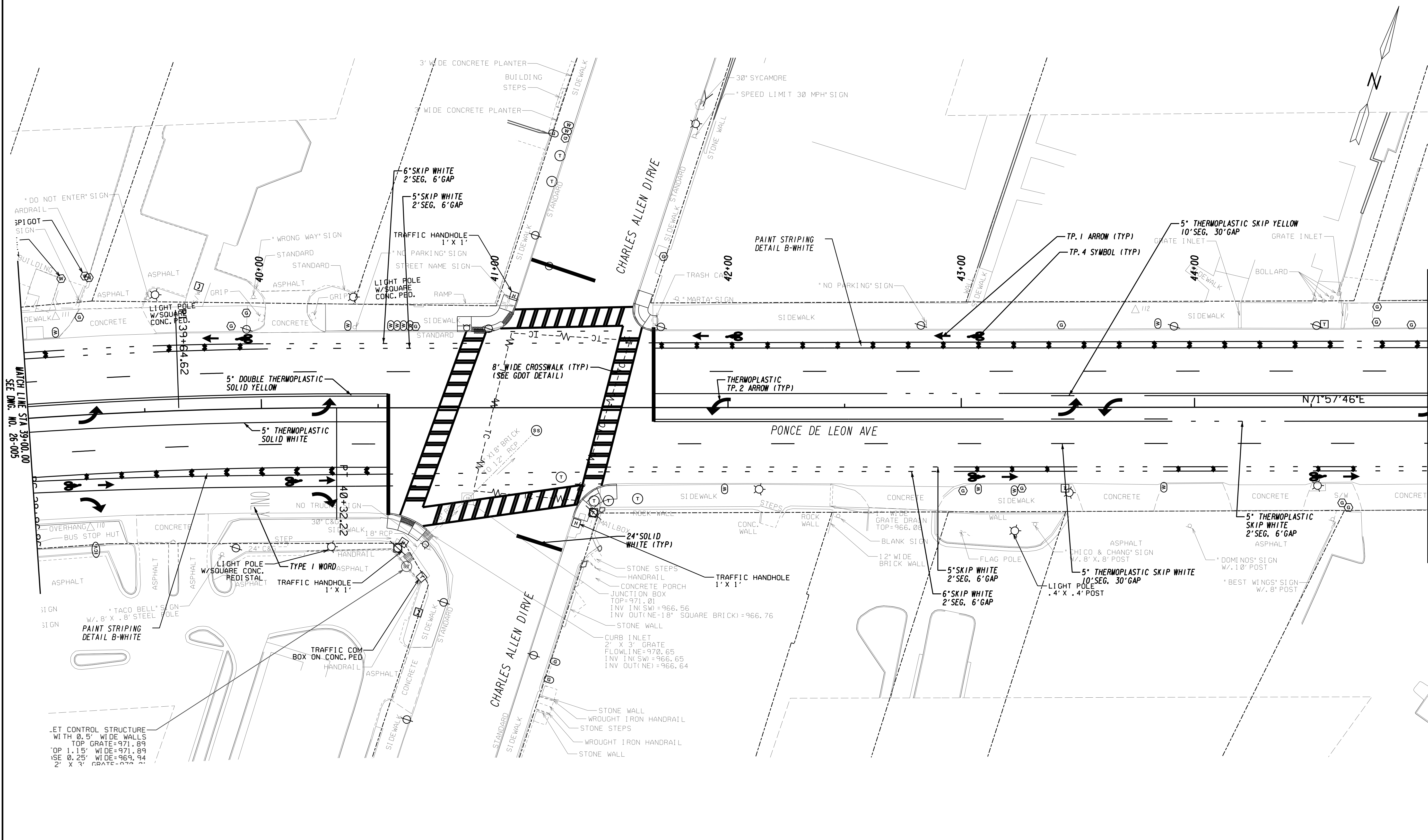

PROPERTY AND EXISTING R/W LINE
 REQUIRED R/W LINE
 CONSTRUCTION LIMITS
 EASEMENT FOR CONSTR
 & MAINTENANCE OF SLOPES
 EASEMENT FOR CONSTR OF SLOPES
 EASEMENT FOR CONSTR OF DRIVES

---@--- BEGIN LIMIT OF ACCESS.....BLA
 ---C--- END LIMIT OF ACCESS.....ELA
 ---F--- LIMIT OF ACCESS
 ---H--- REQ'D R/W & LIMIT OF ACCESS

GEORGIA
 DEPARTMENT
 OF
 TRANSPORTATION

URS 400 NORTHPARK TOWN CENTER
 1000 ABERNATHY ROAD, N.E., SUITE 900
 ATLANTA, GEORGIA 30328
 TEL: (678) 808-8800 FAX: (678) 808-8400

SCALE IN FEET
 0 20 40 80

REVISION DATES		

STATE OF GEORGIA
 DEPARTMENT OF TRANSPORTATION
 OFFICE: PROGRAM DELIVERY
SIGNING AND MARKING PLANS

SR 8 (PONCE DE LEON AVENUE)
 PEDESTRIAN SAFETY IMPROVEMENT

DRAWING No.
26-006

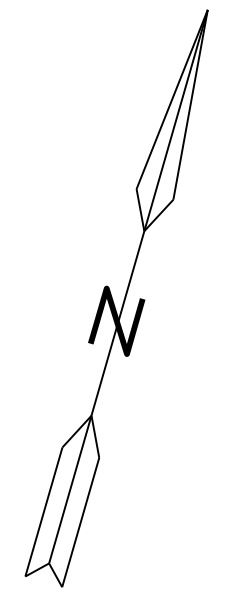
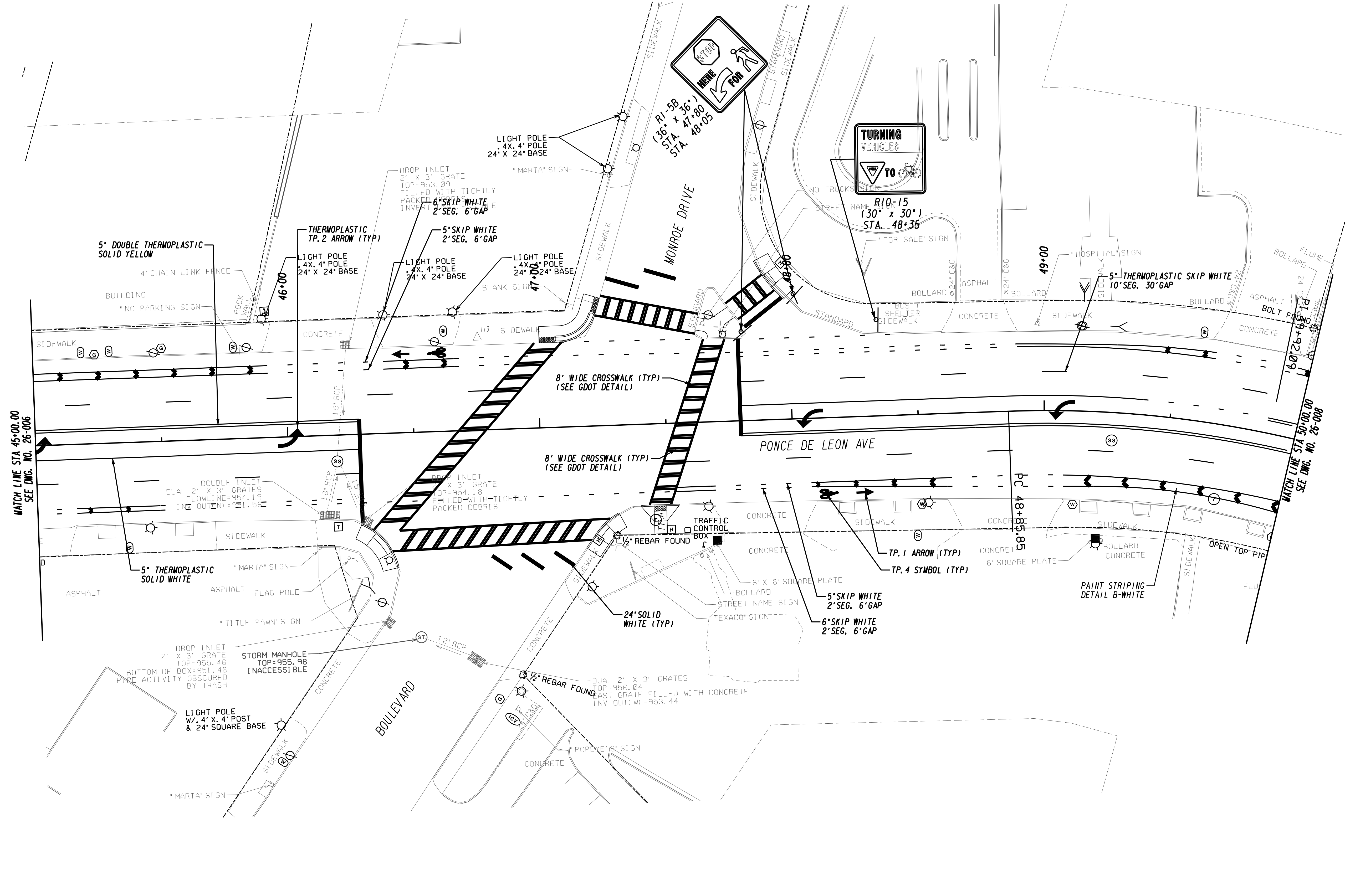

PROPERTY AND EXISTING R/W LINE
 REQUIRED R/W LINE
 CONSTRUCTION LIMITS
 EASEMENT FOR CONSTR
 & MAINTENANCE OF SLOPES
 EASEMENT FOR CONSTR OF SLOPES
 EASEMENT FOR CONSTR OF DRIVES

---@--- BEGIN LIMIT OF ACCESS.....BLA
 ---@--- END LIMIT OF ACCESS.....ELA
 ---@--- LIMIT OF ACCESS
 ---@--- REQ'D R/W & LIMIT OF ACCESS

GEORGIA
 DEPARTMENT
 OF
 TRANSPORTATION

URS 400 NORTHPARK TOWN CENTER
 1000 ABERNATHY ROAD, N.E., SUITE 900
 ATLANTA, GEORGIA 30328
 TEL: (678) 908-8800 FAX: (678) 808-8400

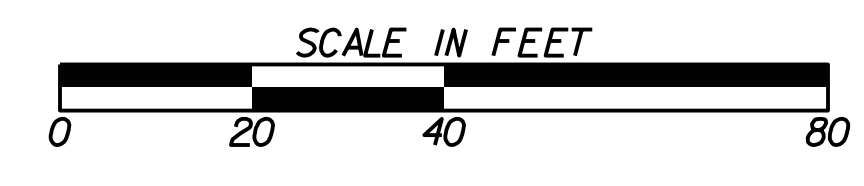

REVISION DATES

STATE OF GEORGIA
 DEPARTMENT OF TRANSPORTATION
 OFFICE: PROGRAM DELIVERY
SIGNING AND MARKING PLANS
 SR 8 (PONCE DE LEON AVENUE)
 PEDESTRIAN SAFETY IMPROVEMENT
 DRAWING No. 26-007

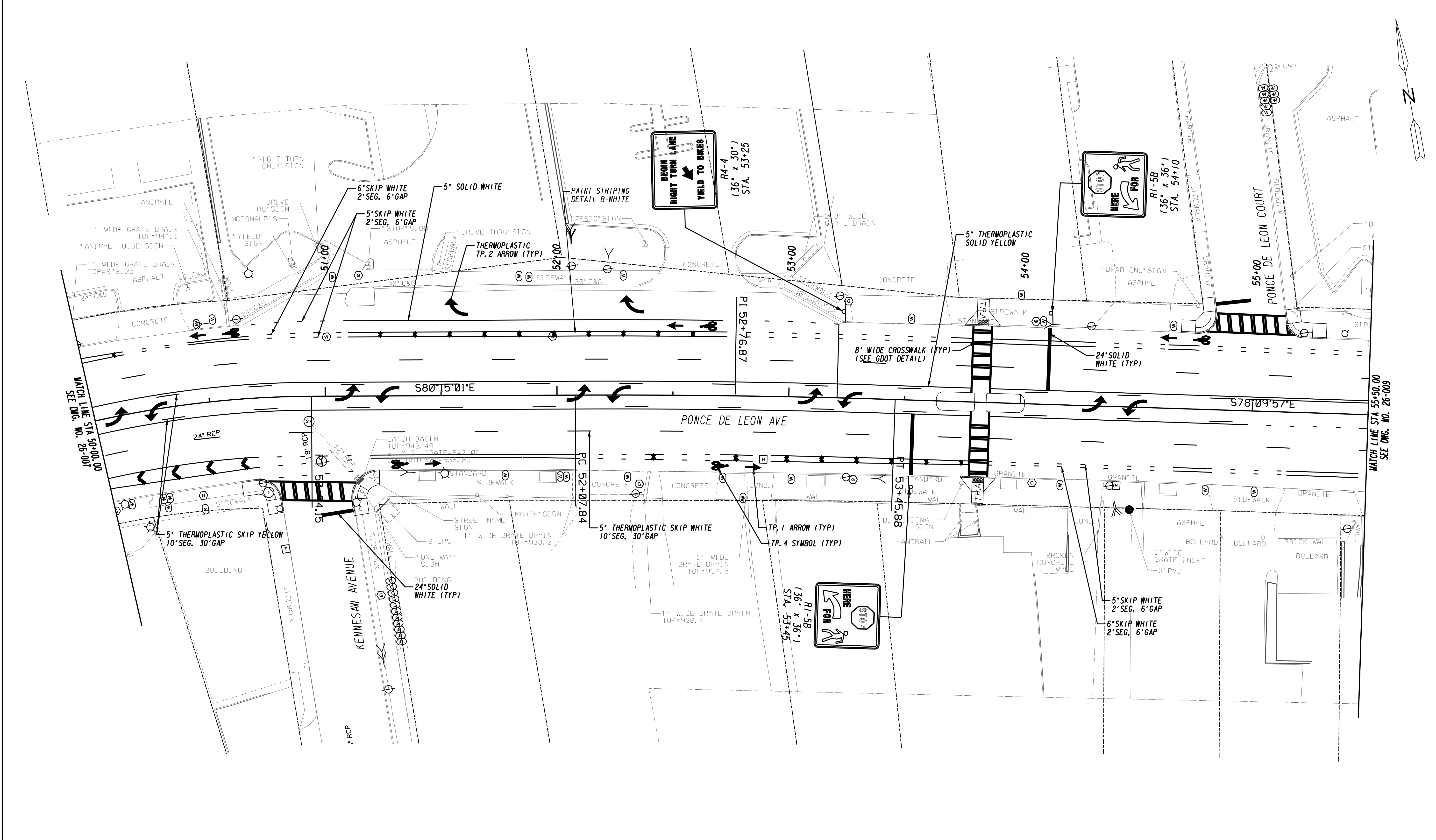

PROPERTY AND EXISTING R/W LINE
 REQUIRED R/W LINE
 CONSTRUCTION LIMITS
 EASEMENT FOR CONSTR
 & MAINTENANCE OF SLOPES
 EASEMENT FOR CONSTR OF SLOPES
 EASEMENT FOR CONSTR OF DRIVES

---@--- BEGIN LIMIT OF ACCESS.....BLA
 ---@--- END LIMIT OF ACCESS.....ELA
 ---@--- LIMIT OF ACCESS
 ---@--- REQ'D R/W & LIMIT OF ACCESS

GEORGIA
 DEPARTMENT
 OF
 TRANSPORTATION

URS 400 NORTHPARK TOWN CENTER
 1000 ABERNATHY ROAD, N.E., SUITE 900
 ATLANTA, GEORGIA 30328
 TEL: (678) 808-8800 FAX: (678) 808-8400

SCALE IN FEET
 0 20 40 80

REVISION DATES

STATE OF GEORGIA
 DEPARTMENT OF TRANSPORTATION
 OFFICE: PROGRAM DELIVERY
SIGNING AND MARKING PLANS

SR 8 (PONCE DE LEON AVENUE)
 PEDESTRIAN SAFETY IMPROVEMENT

DRAWING No.
26-008

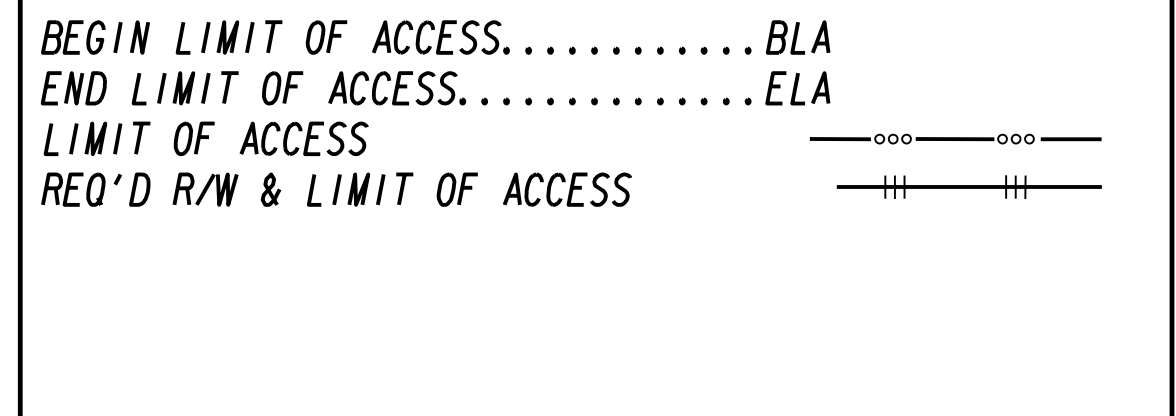
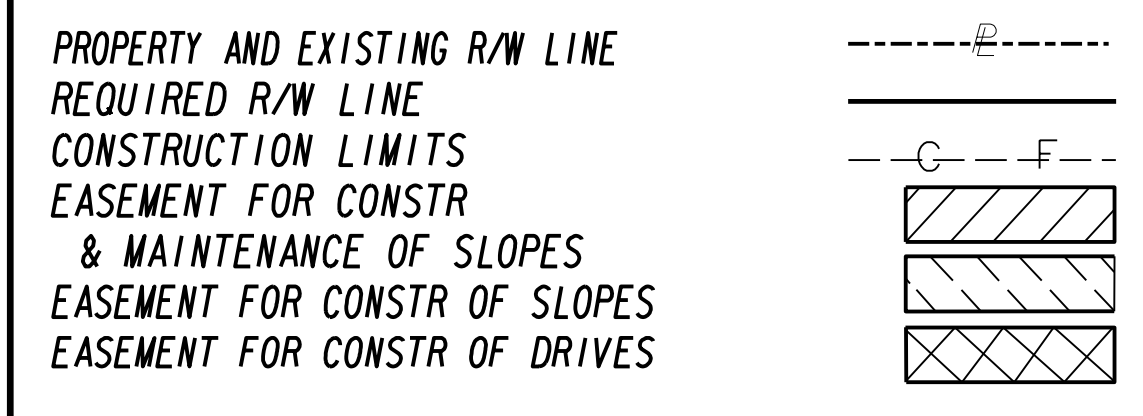
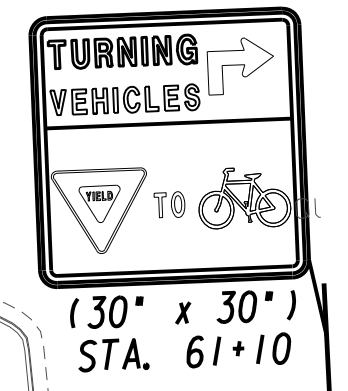
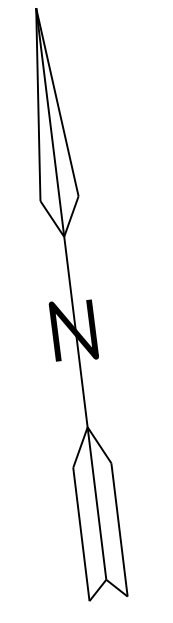
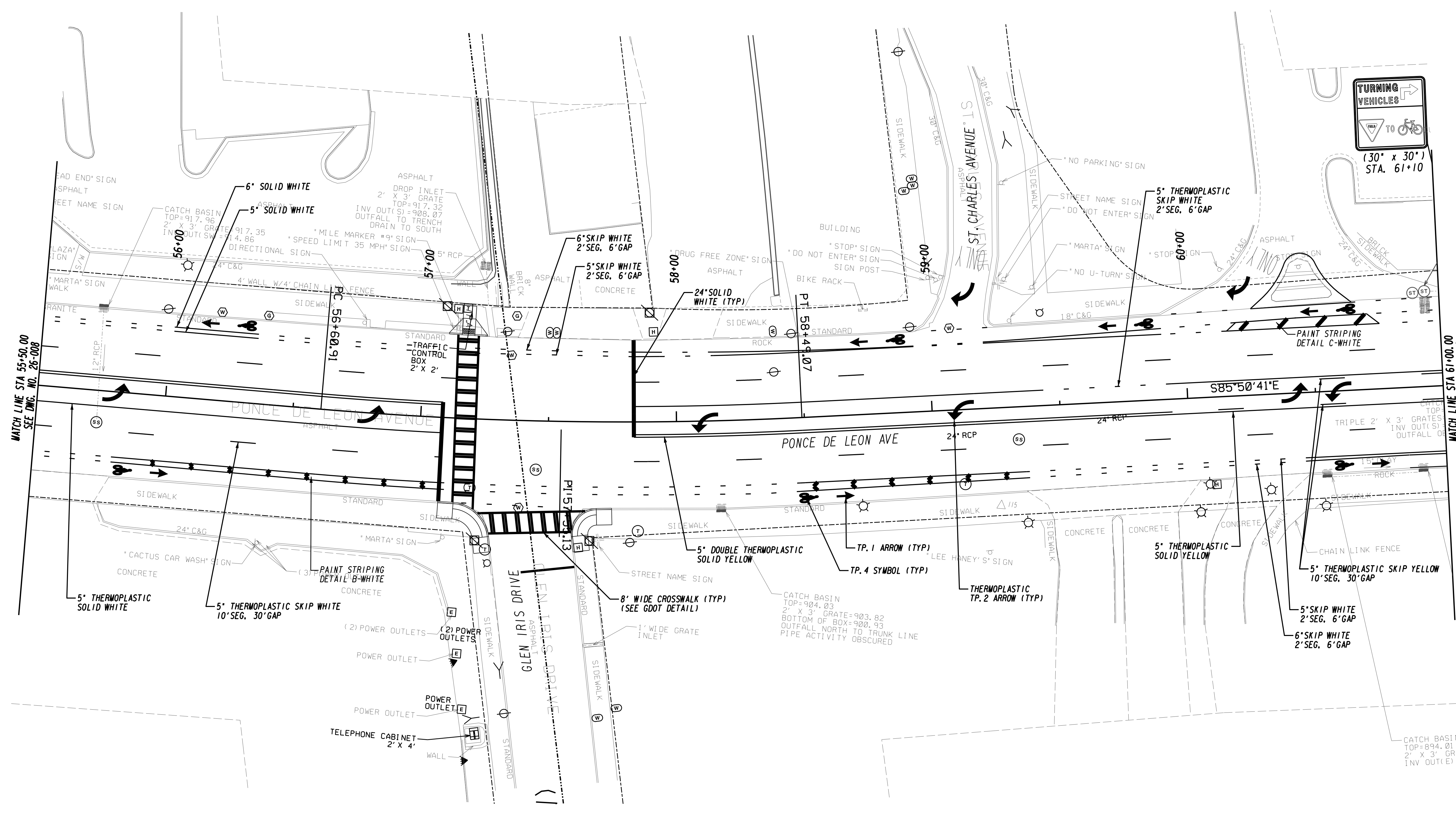

GEORGIA
 DEPARTMENT
 OF
 TRANSPORTATION

URS 400 NORTHPARK TOWN CENTER
 1000 ABERNATHY ROAD, N.E., SUITE 900
 ATLANTA, GEORGIA 30328
 TEL: (678) 808-8800 FAX: (678) 808-8400

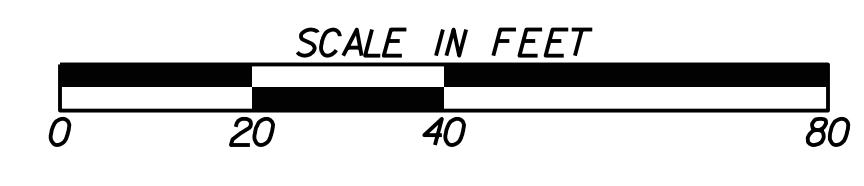

REVISION DATES

STATE OF GEORGIA
 DEPARTMENT OF TRANSPORTATION
 OFFICE: PROGRAM DELIVERY
SIGNING AND MARKING PLANS
 SR 8 (PONCE DE LEON AVENUE)
 PEDESTRIAN SAFETY IMPROVEMENT
 DRAWING No. 26-009

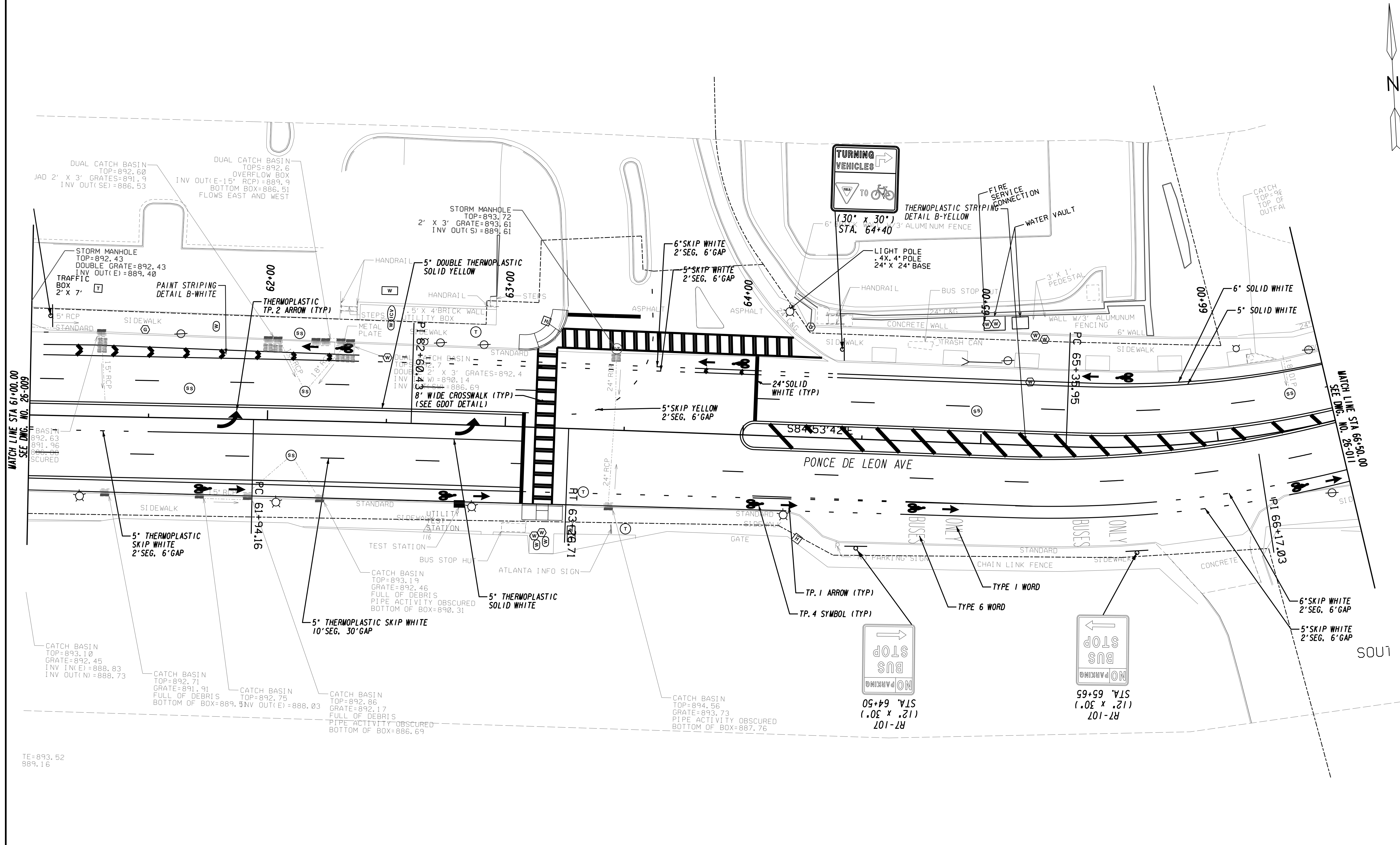

PROPERTY AND EXISTING R/W LINE
 REQUIRED R/W LINE
 CONSTRUCTION LIMITS
 EASEMENT FOR CONSTR
 & MAINTENANCE OF SLOPES
 EASEMENT FOR CONSTR OF SLOPES
 EASEMENT FOR CONSTR OF DRIVES

---@--- BEGIN LIMIT OF ACCESS.....BLA
 ---@--- END LIMIT OF ACCESS.....ELA
 ---@--- LIMIT OF ACCESS
 ---@--- REQ'D R/W & LIMIT OF ACCESS

GEORGIA
 DEPARTMENT
 OF
 TRANSPORTATION

URS
 400 NORTHPARK TOWN CENTER
 1000 ABERNATHY ROAD, N.E., SUITE 900
 ATLANTA, GEORGIA 30328
 TEL: (678) 908-8800 FAX: (678) 808-8400

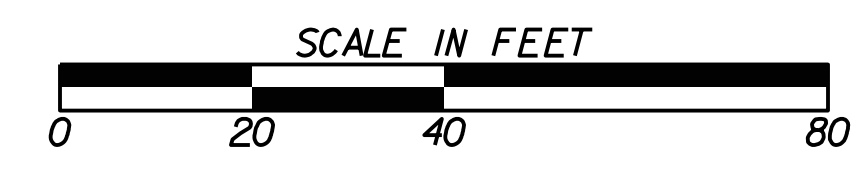

REVISION DATES	

STATE OF GEORGIA
 DEPARTMENT OF TRANSPORTATION
 OFFICE: PROGRAM DELIVERY
SIGNING AND MARKING PLANS
 SR 8 (PONCE DE LEON AVENUE)
 PEDESTRIAN SAFETY IMPROVEMENT
 DRAWING No. 26-010

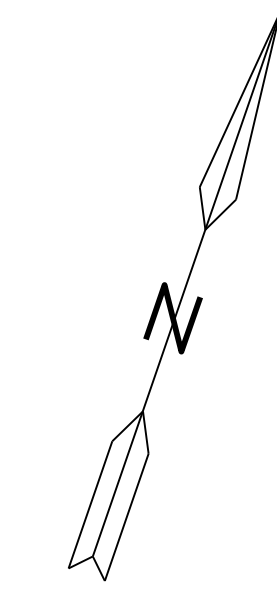
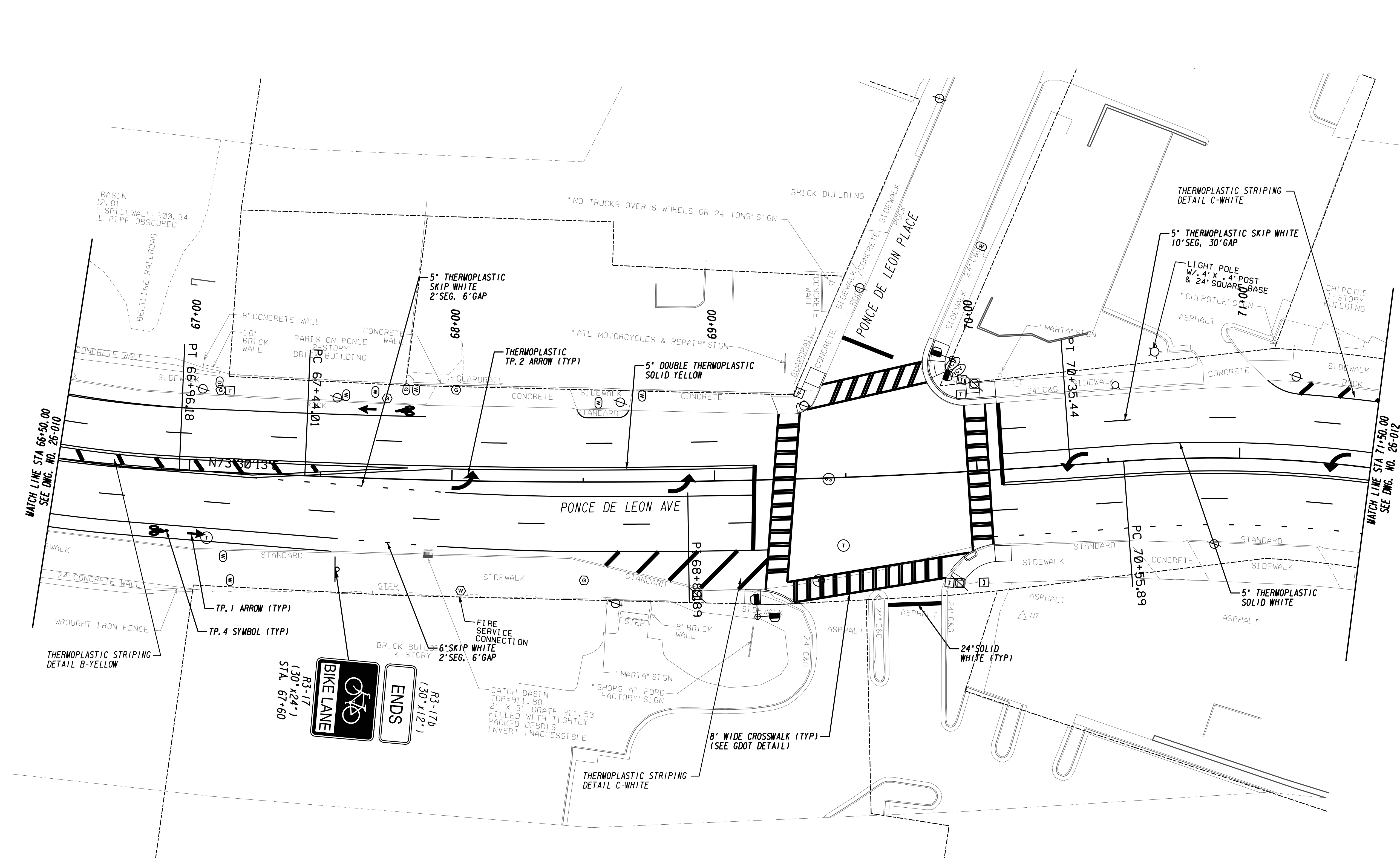

PROPERTY AND EXISTING R/W LINE	---
REQUIRED R/W LINE	---
CONSTRUCTION LIMITS	---
EASEMENT FOR CONSTR & MAINTENANCE OF SLOPES	---
EASEMENT FOR CONSTR OF SLOPES	---
EASEMENT FOR CONSTR OF DRIVES	---

BEGIN LIMIT OF ACCESS.....BLA	---
END LIMIT OF ACCESS.....ELA	---
LIMIT OF ACCESS	---
REQ'D R/W & LIMIT OF ACCESS	---

GEORGIA
 DEPARTMENT
 OF
 TRANSPORTATION

URS
 400 NORTHPARK TOWN CENTER
 1000 ABERNATHY ROAD, N.E., SUITE 900
 ATLANTA, GEORGIA 30328
 TEL: (678) 908-8800 FAX: (678) 808-8400

SCALE IN FEET

REVISION DATES		

STATE OF GEORGIA
 DEPARTMENT OF TRANSPORTATION
 OFFICE: PROGRAM DELIVERY
SIGNING AND MARKING PLANS

SR 8 (PONCE DE LEON AVENUE)
 PEDESTRIAN SAFETY IMPROVEMENT

DRAWING No.
26-011

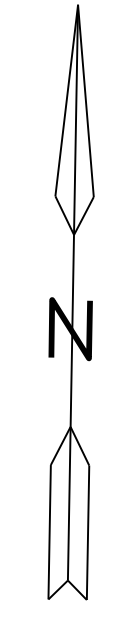
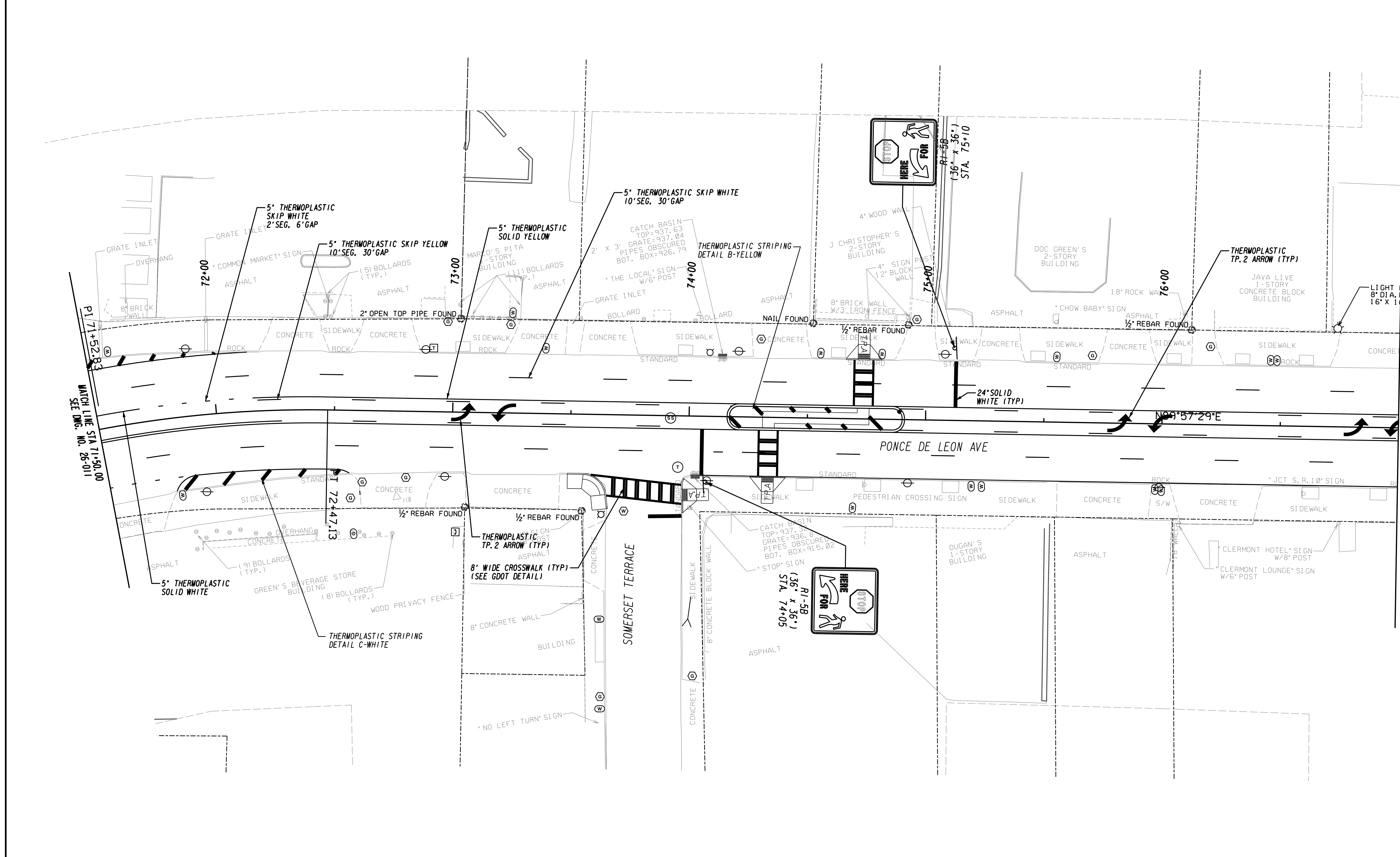

PROPERTY AND EXISTING R/W LINE	---
REQUIRED R/W LINE	---
CONSTRUCTION LIMITS	---
EASEMENT FOR CONSTR & MAINTENANCE OF SLOPES	---
EASEMENT FOR CONSTR OF SLOPES	---
EASEMENT FOR CONSTR OF DRIVES	---

BEGIN LIMIT OF ACCESS.....BLA	---
END LIMIT OF ACCESS.....ELA	---
LIMIT OF ACCESS	---
REQ'D R/W & LIMIT OF ACCESS	---

GEORGIA
DEPARTMENT
OF
TRANSPORTATION

URS 400 NORTHPARK TOWN CENTER
1000 ABERNATHY ROAD, N.E., SUITE 900
ATLANTA, GEORGIA 30328
TEL: (678) 808-8800 FAX: (678) 808-8400

SCALE IN FEET

REVISION DATES		

STATE OF GEORGIA
DEPARTMENT OF TRANSPORTATION

OFFICE: PROGRAM DELIVERY

SIGNING AND MARKING PLANS

SR 8 (PONCE DE LEON AVENUE)
PEDESTRIAN SAFETY IMPROVEMENT

DRAWING No.
26-012

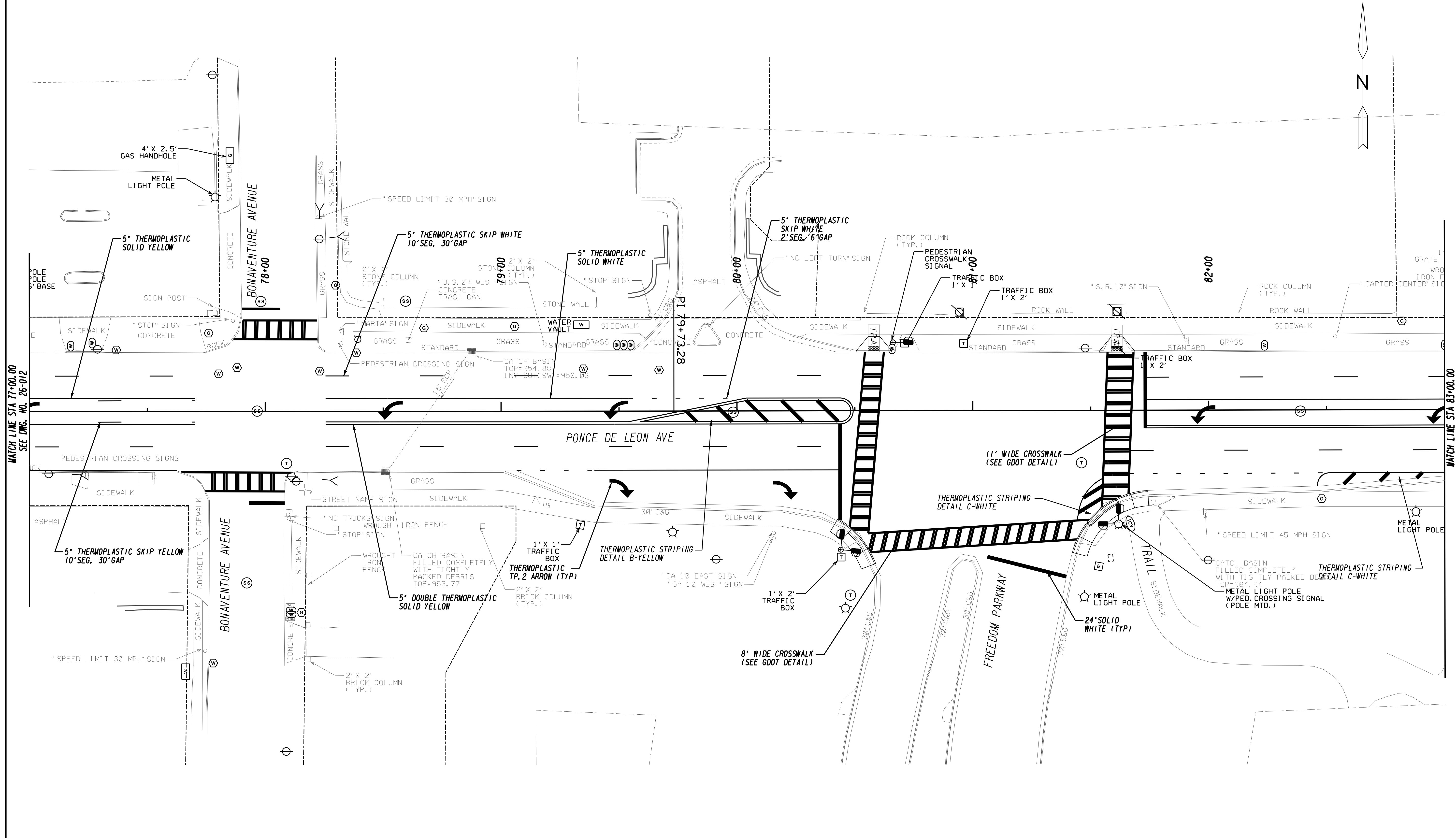

PROPERTY AND EXISTING R/W LINE
 REQUIRED R/W LINE
 CONSTRUCTION LIMITS
 EASEMENT FOR CONSTR
 & MAINTENANCE OF SLOPES
 EASEMENT FOR CONSTR OF SLOPES
 EASEMENT FOR CONSTR OF DRIVES

BEGIN LIMIT OF ACCESS.....BLA
 END LIMIT OF ACCESS.....ELA
 LIMIT OF ACCESS
 REQ'D R/W & LIMIT OF ACCESS

GEORGIA
 DEPARTMENT
 OF
 TRANSPORTATION

URS
 400 NORTHPARK TOWN CENTER
 1000 ABERNATHY ROAD, N.E., SUITE 900
 ATLANTA, GEORGIA 30328
 TEL: (678) 908-8800 FAX: (678) 808-8400

SCALE IN FEET
 0 20 40 80

REVISION DATES

STATE OF GEORGIA
 DEPARTMENT OF TRANSPORTATION
 OFFICE: PROGRAM DELIVERY
SIGNING AND MARKING PLANS

SR 8 (PONCE DE LEON AVENUE)
 PEDESTRIAN SAFETY IMPROVEMENT

DRAWING No.
 26-013

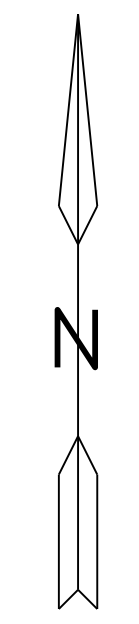
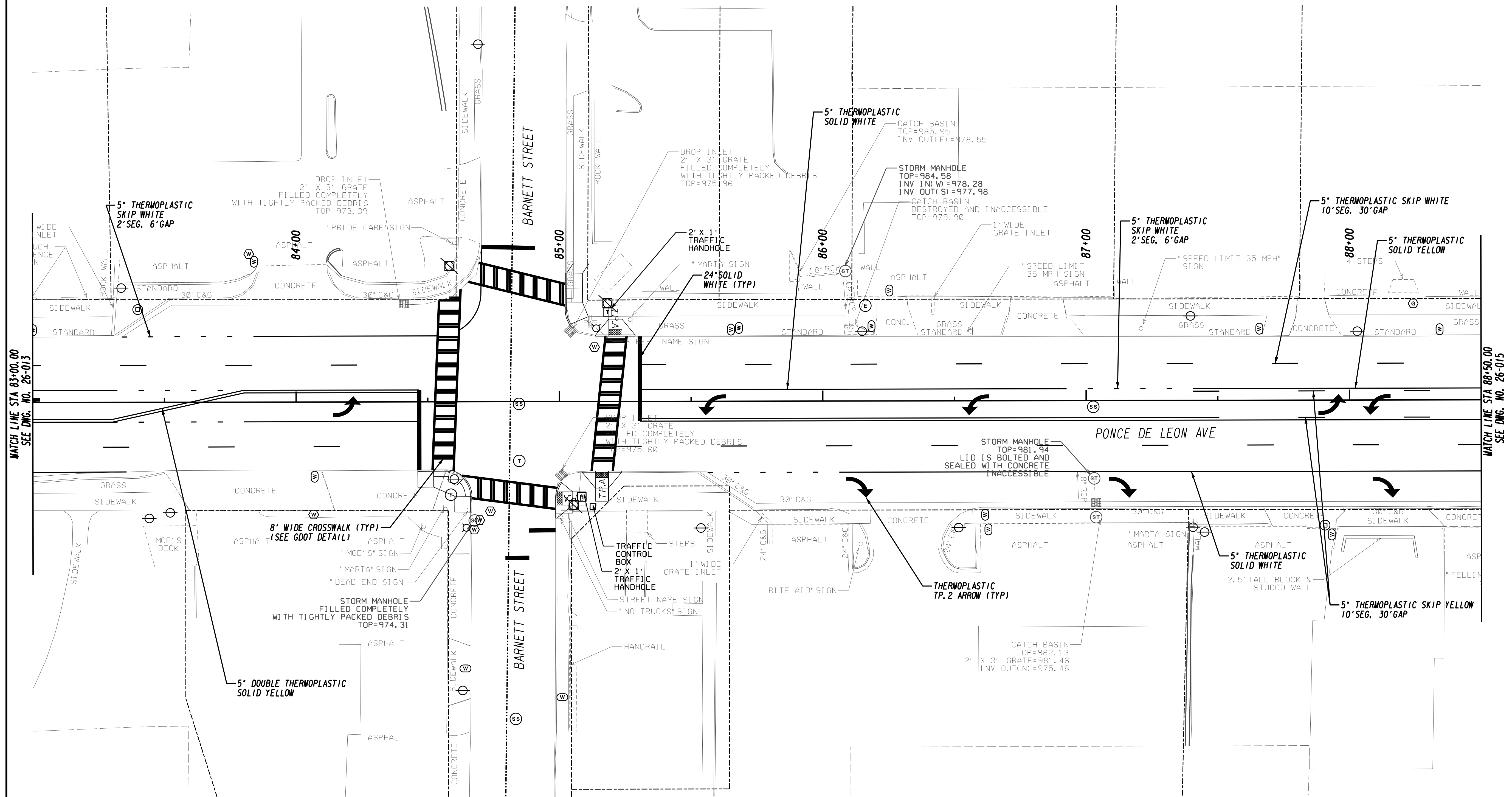

PROPERTY AND EXISTING R/W LINE
 REQUIRED R/W LINE
 CONSTRUCTION LIMITS
 EASEMENT FOR CONSTR
 & MAINTENANCE OF SLOPES
 EASEMENT FOR CONSTR OF SLOPES
 EASEMENT FOR CONSTR OF DRIVES

---@--- BEGIN LIMIT OF ACCESS.....BLA
 ---C--- END LIMIT OF ACCESS.....ELA
 ---F--- LIMIT OF ACCESS
 ---X--- REQ'D R/W & LIMIT OF ACCESS

GEORGIA
 DEPARTMENT
 OF
 TRANSPORTATION

URS 400 NORTHPARK TOWN CENTER
 1000 ABERNATHY ROAD, N.E., SUITE 900
 ATLANTA, GEORGIA 30328
 TEL: (678) 808-8800 FAX: (678) 808-8400

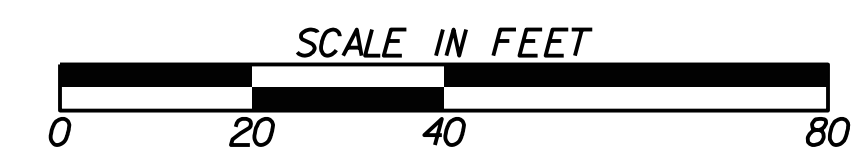

REVISION DATES	

STATE OF GEORGIA
 DEPARTMENT OF TRANSPORTATION
 OFFICE: PROGRAM DELIVERY
SIGNING AND MARKING PLANS
 SR 8 (PONCE DE LEON AVENUE)
 PEDESTRIAN SAFETY IMPROVEMENT
 DRAWING No. 26-014

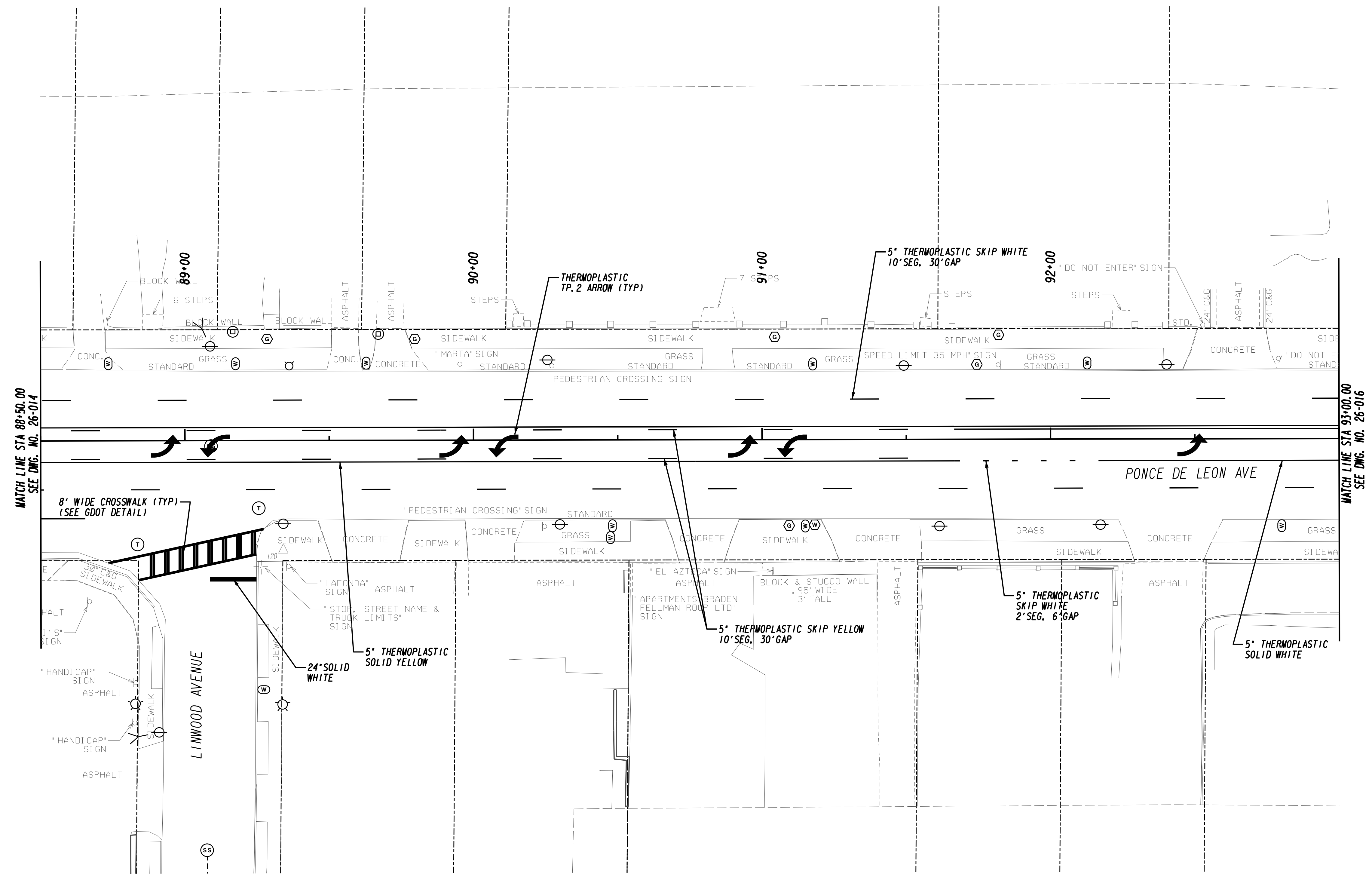

PROPERTY AND EXISTING R/W LINE
 REQUIRED R/W LINE
 CONSTRUCTION LIMITS
 EASEMENT FOR CONSTR
 & MAINTENANCE OF SLOPES
 EASEMENT FOR CONSTR OF SLOPES
 EASEMENT FOR CONSTR OF DRIVES

---@--- BEGIN LIMIT OF ACCESS.....BLA
 ---@--- END LIMIT OF ACCESS.....ELA
 ---@--- LIMIT OF ACCESS
 ---@--- REQ'D R/W & LIMIT OF ACCESS

GEORGIA
 DEPARTMENT
 OF
 TRANSPORTATION

URS 400 NORTHPARK TOWN CENTER
 1000 ABERNATHY ROAD, N.E., SUITE 900
 ATLANTA, GEORGIA 30328
 TEL: (678) 908-8800 FAX: (678) 908-8400

SCALE IN FEET
 0 20 40 80

REVISION DATES	

STATE OF GEORGIA
 DEPARTMENT OF TRANSPORTATION
 OFFICE: PROGRAM DELIVERY
SIGNING AND MARKING PLANS

SR 8 (PONCE DE LEON AVENUE)
 PEDESTRIAN SAFETY IMPROVEMENT

DRAWING No.
26-015

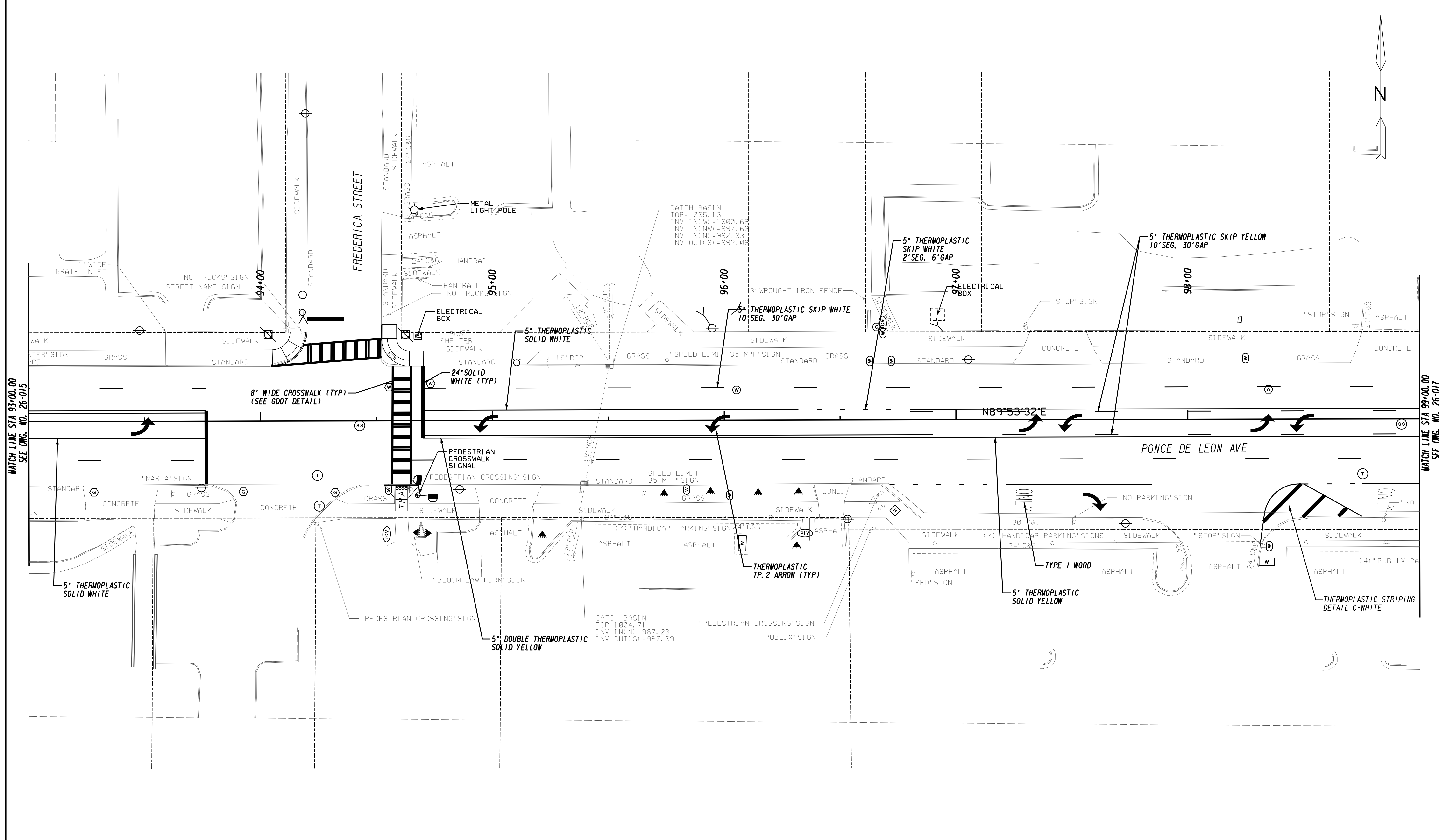

PROPERTY AND EXISTING R/W LINE	---
REQUIRED R/W LINE	---
CONSTRUCTION LIMITS	---C---F---
EASEMENT FOR CONSTR & MAINTENANCE OF SLOPES	[Hatched Box]
EASEMENT FOR CONSTR OF SLOPES	[Hatched Box]
EASEMENT FOR CONSTR OF DRIVES	[Hatched Box]

BEGIN LIMIT OF ACCESS.....BLA	---
END LIMIT OF ACCESS.....ELA	---
LIMIT OF ACCESS	---
REQ'D R/W & LIMIT OF ACCESS	---

GEORGIA
DEPARTMENT
OF
TRANSPORTATION

URS
400 NORTHPARK TOWN CENTER
1000 ABERNATHY ROAD, N.E., SUITE 900
ATLANTA, GEORGIA 30328
TEL: (678) 808-8800 FAX: (678) 808-8400

SCALE IN FEET
0 20 40 80

REVISION DATES		

STATE OF GEORGIA
DEPARTMENT OF TRANSPORTATION
OFFICE: PROGRAM DELIVERY
SIGNING AND MARKING PLANS

SR 8 (PONCE DE LEON AVENUE)
PEDESTRIAN SAFETY IMPROVEMENT

DRAWING No.
26-016

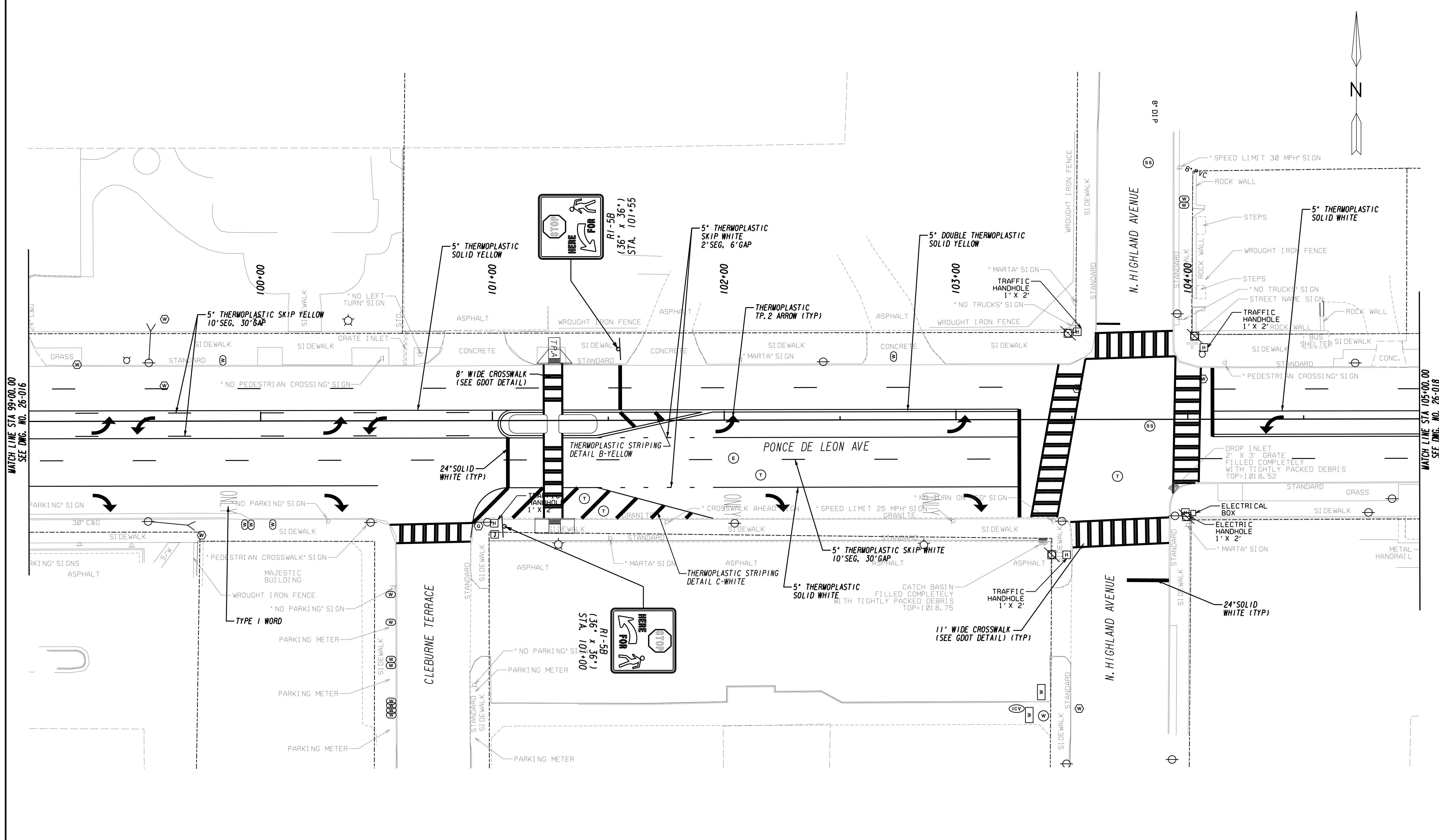

PROPERTY AND EXISTING R/W LINE
 REQUIRED R/W LINE
 CONSTRUCTION LIMITS
 EASEMENT FOR CONSTR
 & MAINTENANCE OF SLOPES
 EASEMENT FOR CONSTR OF SLOPES
 EASEMENT FOR CONSTR OF DRIVES

---@--- BEGIN LIMIT OF ACCESS.....BLA
 ---@--- END LIMIT OF ACCESS.....ELA
 ---@--- LIMIT OF ACCESS
 ---@--- REQ'D R/W & LIMIT OF ACCESS

GEORGIA
 DEPARTMENT
 OF
 TRANSPORTATION

URS
 400 NORTHPARK TOWN CENTER
 1000 ABERNATHY ROAD, N.E., SUITE 900
 ATLANTA, GEORGIA 30328
 TEL: (678) 908-8800 FAX: (678) 908-8400

SCALE IN FEET
 0 20 40 80

REVISION DATES

STATE OF GEORGIA
 DEPARTMENT OF TRANSPORTATION
 OFFICE: PROGRAM DELIVERY

SIGNING AND MARKING PLANS

SR 8 (PONCE DE LEON AVENUE)
 PEDESTRIAN SAFETY IMPROVEMENT

DRAWING No.
 26-017

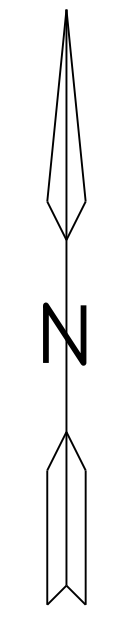
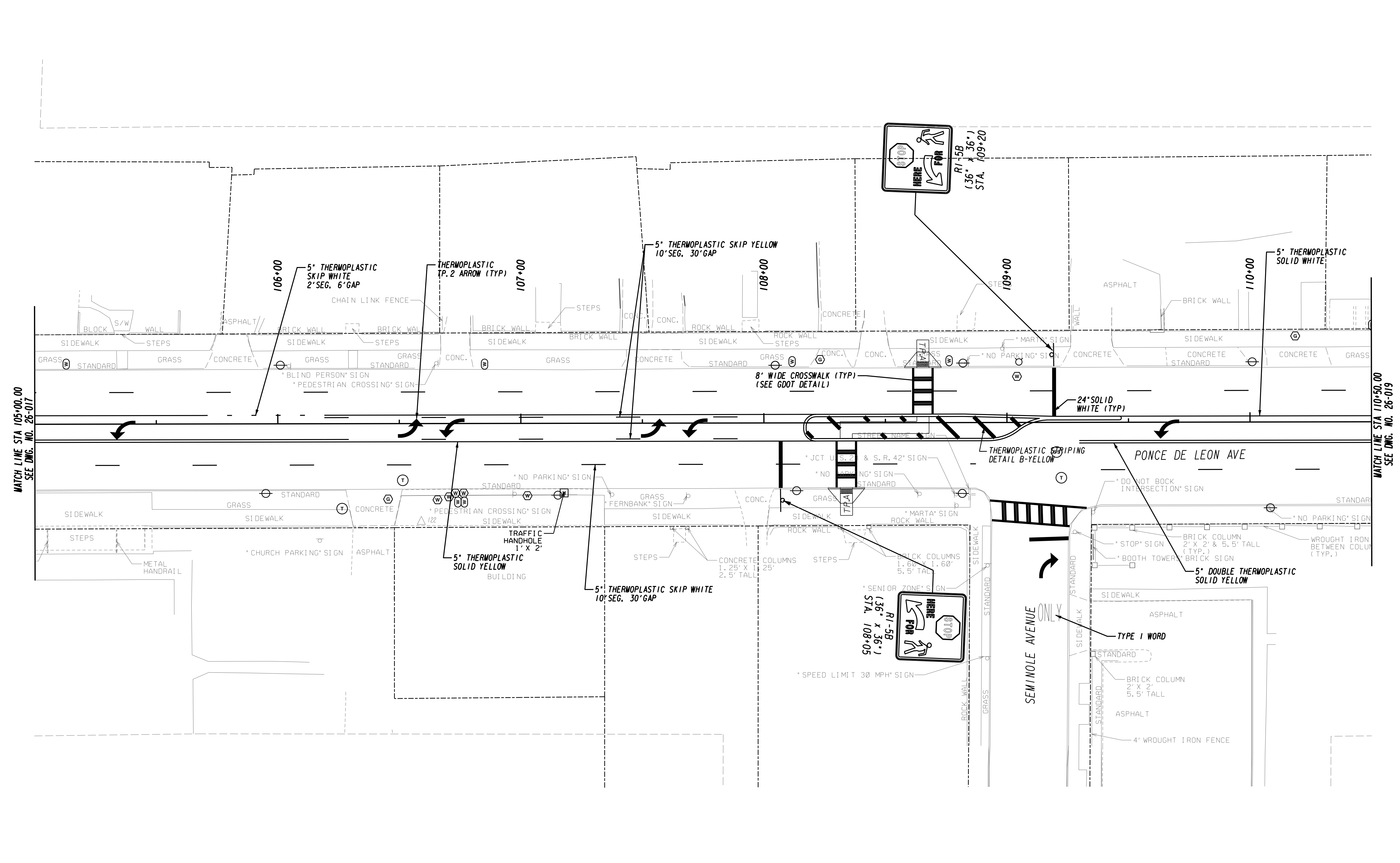

MATCH LINE STA 105+00.00
SEE DWG. NO. 26-017

MATCH LINE STA 110+50.00
SEE DWG. NO. 26-019

PROPERTY AND EXISTING R/W LINE	---
REQUIRED R/W LINE	---
CONSTRUCTION LIMITS	---
EASEMENT FOR CONSTR & MAINTENANCE OF SLOPES	---C---F---
EASEMENT FOR CONSTR OF SLOPES	---C---F---
EASEMENT FOR CONSTR OF DRIVES	---C---F---

BEGIN LIMIT OF ACCESS.....BLA	---
END LIMIT OF ACCESS.....ELA	---
LIMIT OF ACCESS	---
REQ'D R/W & LIMIT OF ACCESS	---

GEORGIA
DEPARTMENT
OF
TRANSPORTATION

URS
 400 NORTHPARK TOWN CENTER
 1000 ABERNATHY ROAD, N.E., SUITE 900
 ATLANTA, GEORGIA 30328
 TEL: (678) 908-8800 FAX: (678) 908-8400

SCALE IN FEET
 0 20 40 80

REVISION DATES		

STATE OF GEORGIA
DEPARTMENT OF TRANSPORTATION
OFFICE: PROGRAM DELIVERY

SIGNING AND MARKING PLANS

SR 8 (PONCE DE LEON AVENUE)
PEDESTRIAN SAFETY IMPROVEMENT

DRAWING No. 26-018

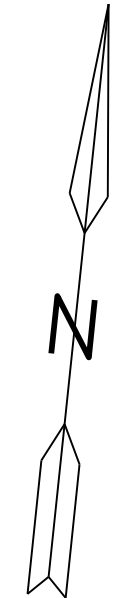
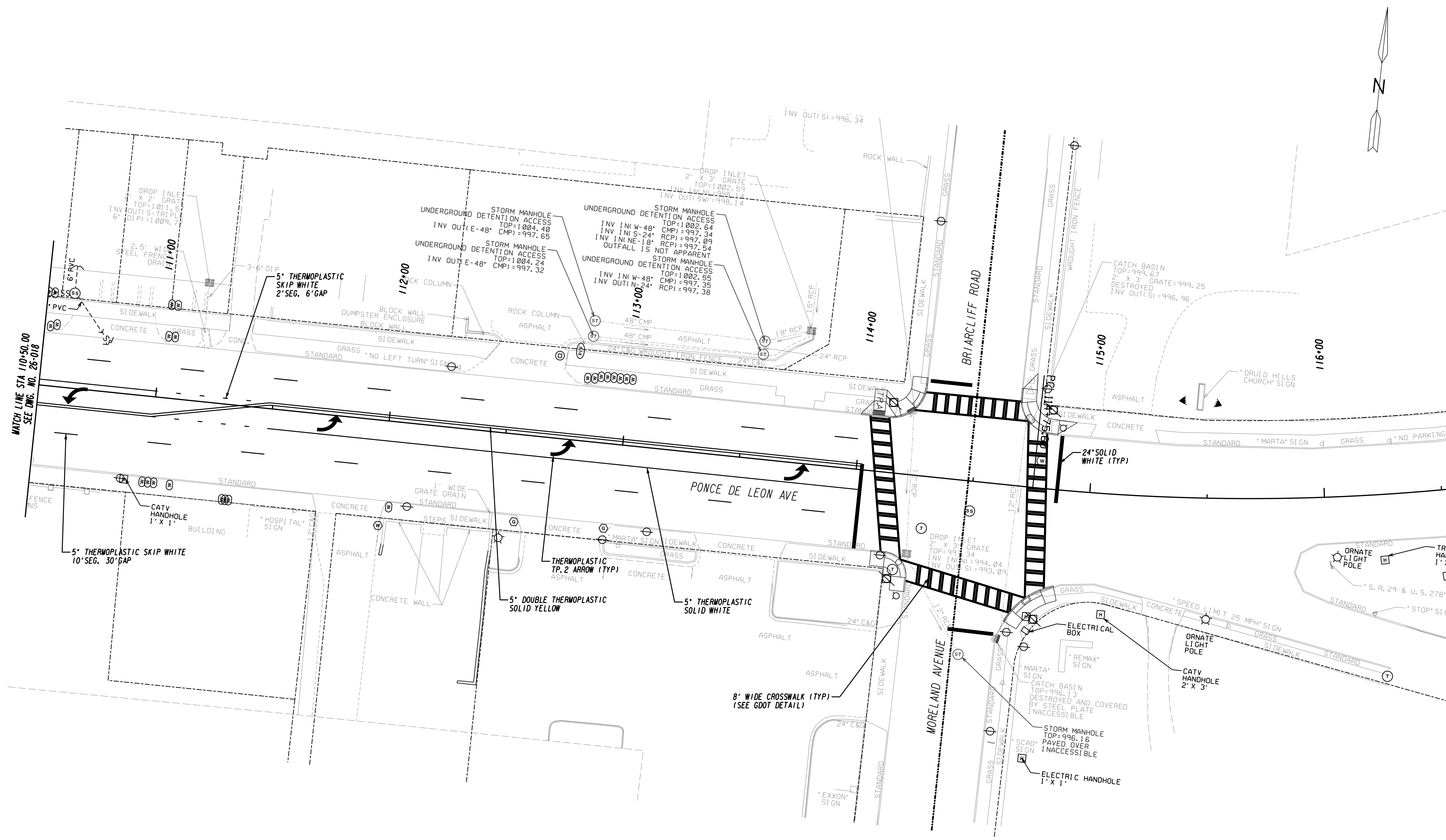

PROPERTY AND EXISTING R/W LINE
 REQUIRED R/W LINE
 CONSTRUCTION LIMITS
 EASEMENT FOR CONSTR
 & MAINTENANCE OF SLOPES
 EASEMENT FOR CONSTR OF SLOPES
 EASEMENT FOR CONSTR OF DRIVES

---@--- BEGIN LIMIT OF ACCESS.....BLA
 ---C--- END LIMIT OF ACCESS.....ELA
 ---F--- LIMIT OF ACCESS
 ---H--- REQ'D R/W & LIMIT OF ACCESS

GEORGIA
 DEPARTMENT
 OF
 TRANSPORTATION

URS
 400 NORTHPARK TOWN CENTER
 1000 ABERNATHY ROAD, N.E., SUITE 900
 ATLANTA, GEORGIA 30328
 TEL: (678) 908-8800 FAX: (678) 808-8400

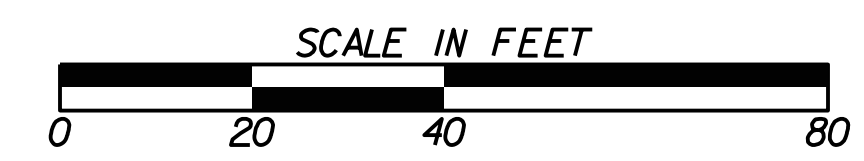

REVISION DATES

STATE OF GEORGIA
 DEPARTMENT OF TRANSPORTATION
 OFFICE: PROGRAM DELIVERY

SIGNING AND MARKING PLANS

SR 8 (PONCE DE LEON AVENUE)
 PEDESTRIAN SAFETY IMPROVEMENT

DRAWING No.
 26-019